

Modularized, Immersion-Cooled, Data Center for Blockchain Computing

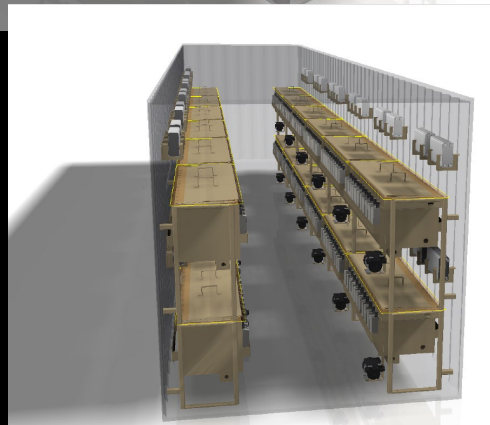

Product Specifications	Shipping Container	
	20 Foot Container	40 Foot Container
Immersion Cooling Tanks	12	24
GPM Pump Capacity	18	18
Approx. Miner Capacity per Tank		
S9	22	22
S19	10	10
Approx. Miner Capacity per Container		
S9	264	528
S19	120	240
120 Plate Heat Exchangers	24	48
External Water Connection	2"	2"
Water Usage-(estimated GPM)	36	36
Container Exhaust Fans (CFM)	950	2000
Electrical		
KVA	300	600
Input Voltage	3-phase 208-240 V	3-phase 208-240 V
Normal Input Amperage	400 A	800 A
LED lighting	Yes	Yes
C13 Plugs Per Tank	24	24
24 Port Gigabit Ethernet Switches	13	25

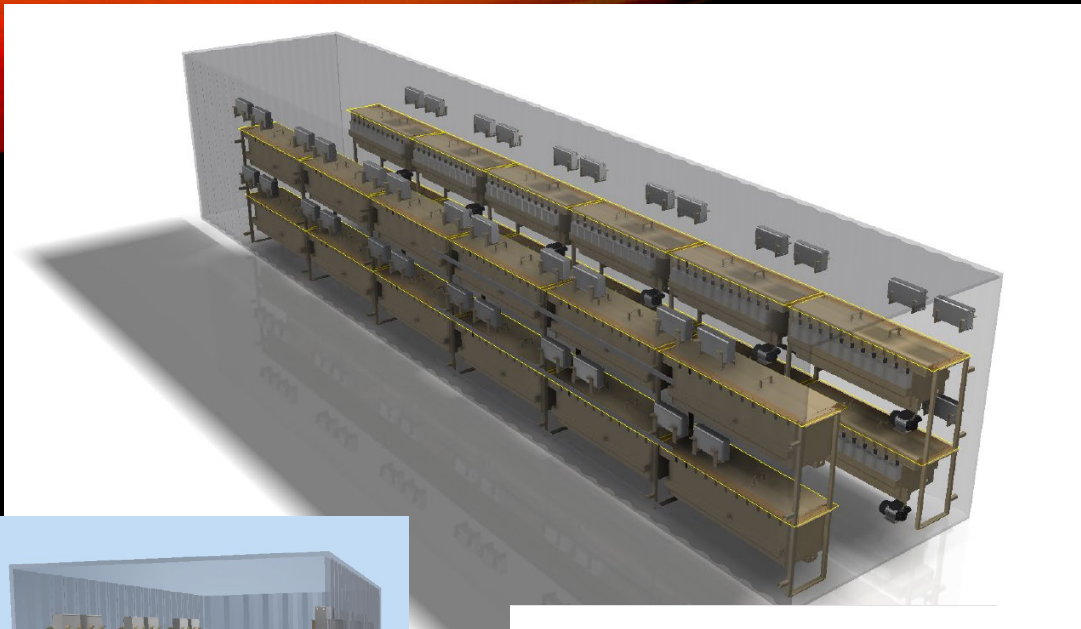
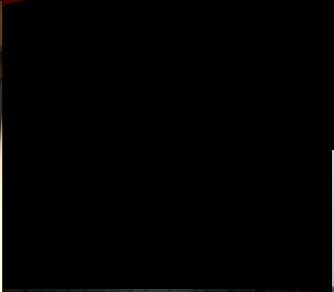

Ready To Use with your Site Preparation & Prerequisites:

- Mining and networking hardware
- Installation site preparation, including electric & water utilities
- Grade level concrete pad (12' x 30' for 20' container or 12' x 50' for 40' container)
- Any applicable permits
- Ongoing water cooling and treatment
- Firewall/routers/wiring to container
- Internet connection for miners
- Bitcoin wallet and mining pool account
- Dielectric fluid

MMC Terms

Payment Terms:

- 50% with Purchase Order
- Balance Prior to Shipping
- FOB Alda, NE 68810

Warranty

- One-Year Limited Warranty on infrastructure
- Switches: Component Manufacturer's Warranty
- Pumps: Component Manufacturer's Warranty
- Heat Exchangers: Component Manufacturer's Warranty

MMC Merrick Machine Company

104 S Apollo St, Alda, NE 68810 [\(308\) 384-1780](tel:3083841780)